

TENT
/ Technical rider

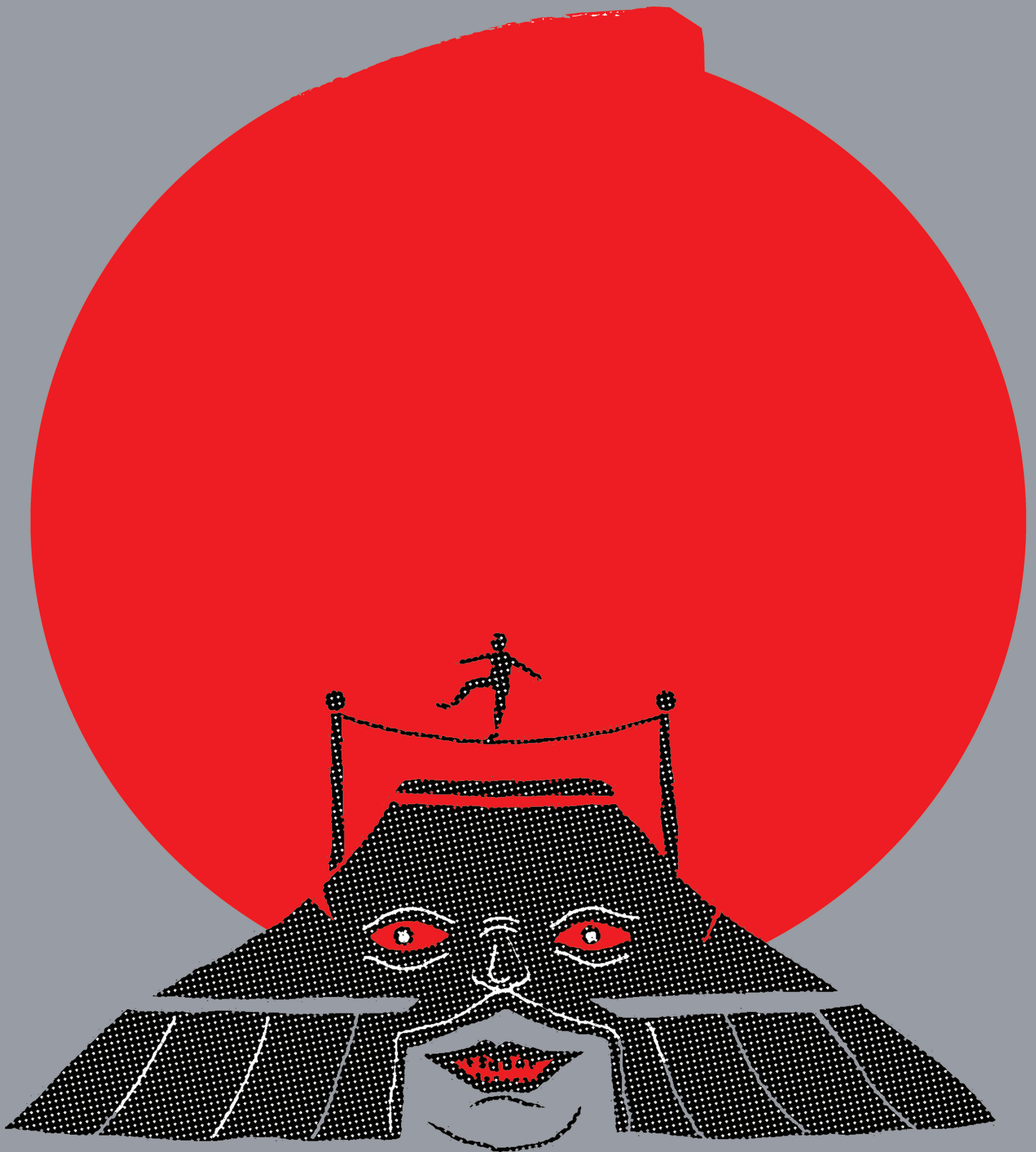

CIRKOBALKANA

CIRKOBALKANA

TECHNICAL DATA

/ CIRKOBALKANA circus tent

/ Minimum space required for instalation of the tent,
with vans and trailers **28mX28m**

/ Diameter – with sideling walls (apse)..... $d1 * = 20m$

/ Diameter - with internal walls..... $d2 ** = 14m$

/ Audience capacity - 170 seats in the stands/tribune,
30 seats on the auxiliary benches in that case there is
a maximum of 200 seats.

/ TENT MATERIAL

/ Tarpaulin - Ferrari 702 - 800 g / m² - light impermeable

/ Construction - Galvanized steel

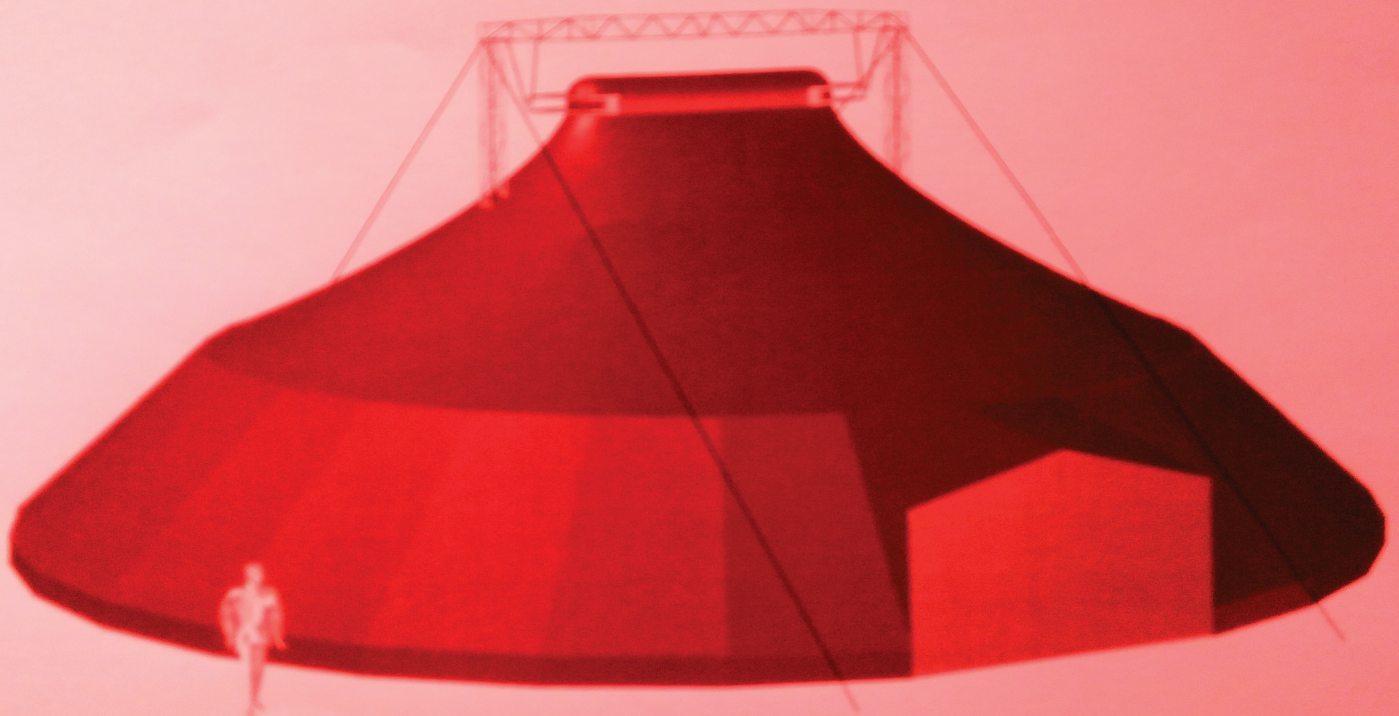

/ CONSTRUCTION FOR THE TENT

/ High of the construction..... 8m

Distance between two main poles..... 6.5m

/ Height inside the tent..... 6.5m

Length of cupola..... 4m

/ Width of cupola..... 0.8m

Height of cupola..... 0.6m

/ Height of the round wall poles..... 3m

Construction - Galvanized steel

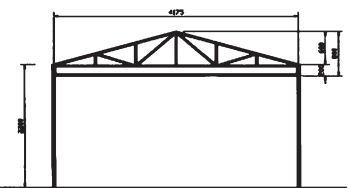
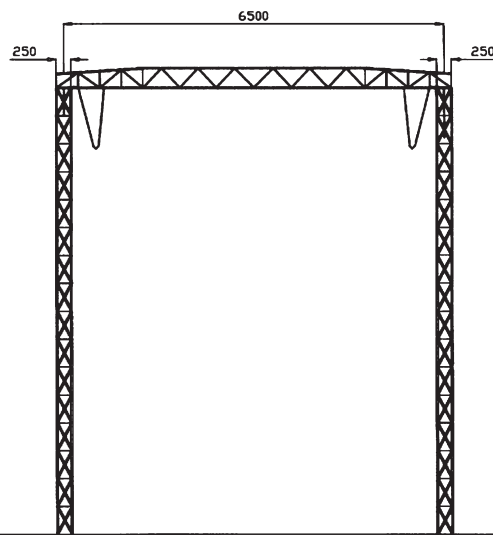
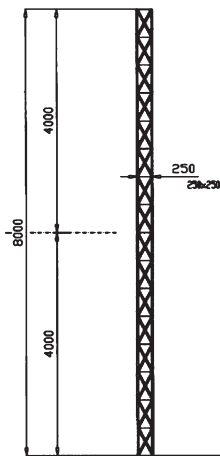
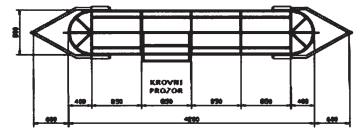
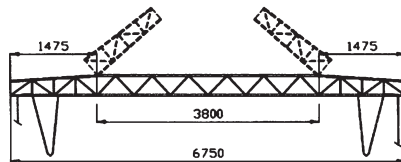

/ ENTRANCE

Entrances: doors..... 2 entrances / 2 exits

Ventilation: window on cupola..... 1



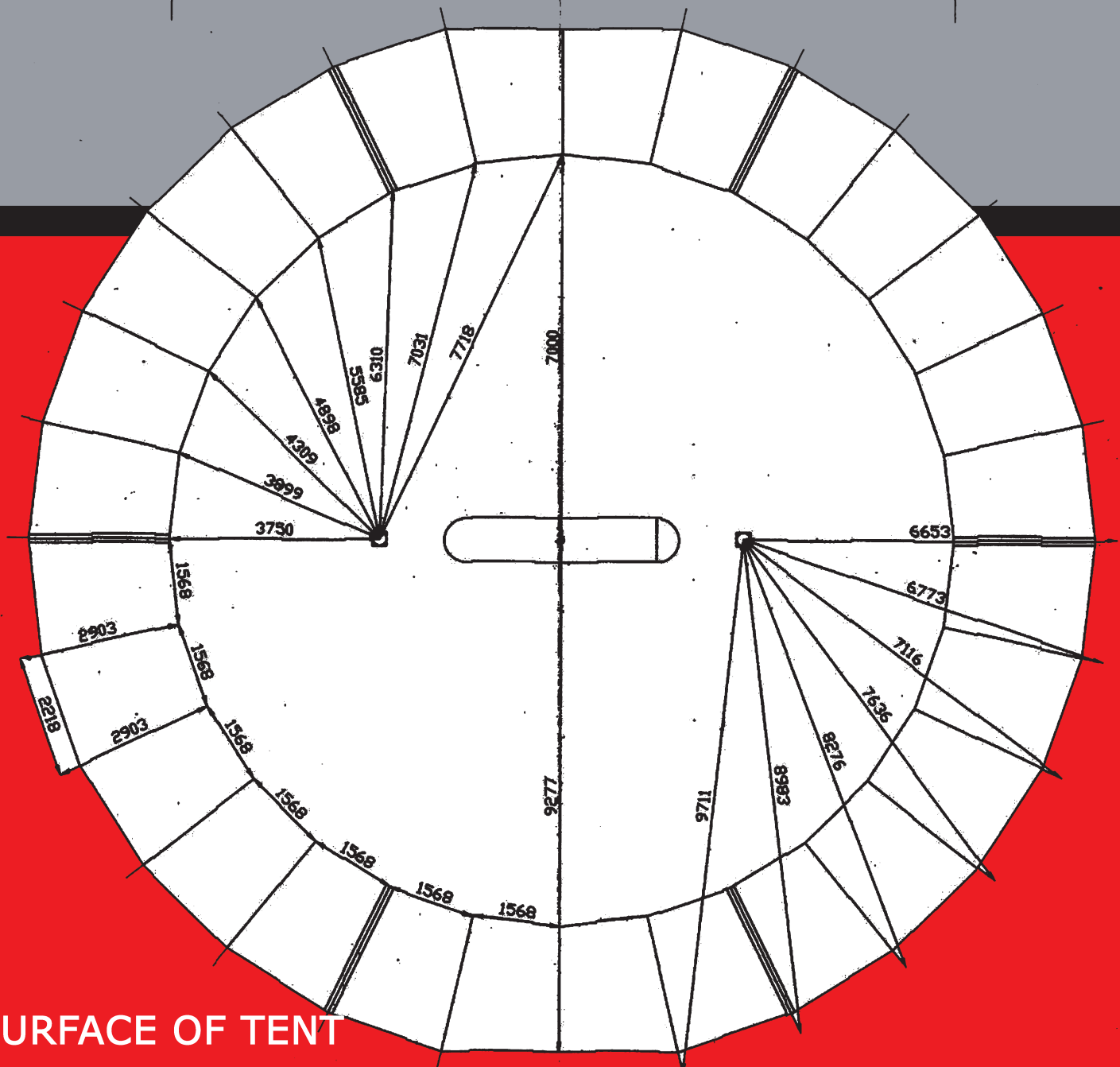

SURFACE OF TENT

- / Surface with d1* -314m² usable for standing with d1* 200m²
- / Surface with d2**-154m²

TENT ANCHORING

- / Anchoring - Pins/Pawls and Pins/still cables
- / Pins 38 pieces / Pawls 42 pieces / Still cables 6 pieces

SECURITY/ SAFETY

- / Resistance to wind - 100 km/h
- / Certificate for tarpaulin/plastic - M2
- / Certificate for steel construction of tent - UNI EN 287-1 135 T FW 1.2 t8 D100 PB ml
- / Additional load tent - up to 1000kg

/INSTALLATION / EQUIPMENT TIME / SETTING UP

/Installation time- 8h

/Installation time with equipment
(lighting, stage, sound) - 16h

/Disassembly time - 6h

/Disassembly time with additional
equipment - 12h

/Number of technicians - 6 persons

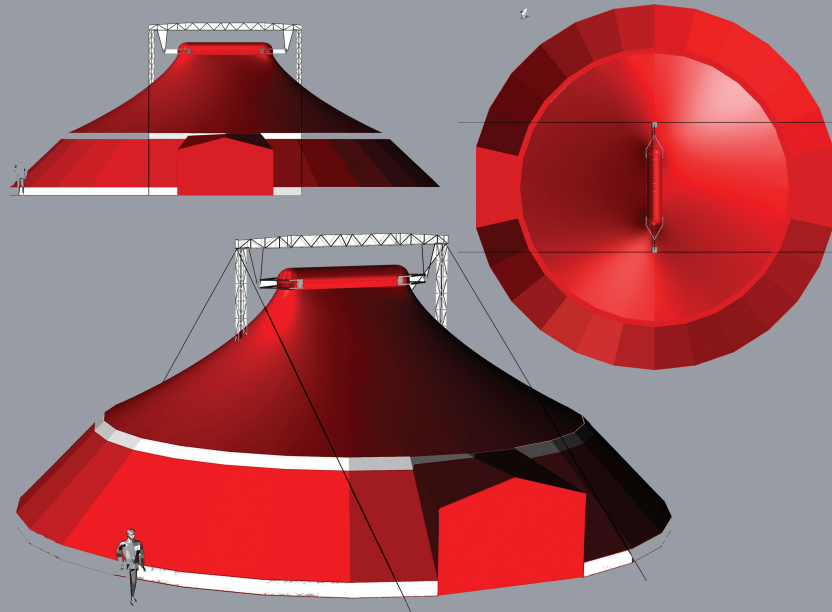

/ TRANSPORT

Transport of tent and technical equipment - 1 van and 1 truck + trailer

Dimensions of the trailer - w = 2.10m x d = 4.60m x v = 3.50m

/ TRIBUNE 170 seats, 4 rows, material: combination of steel structure
and wood

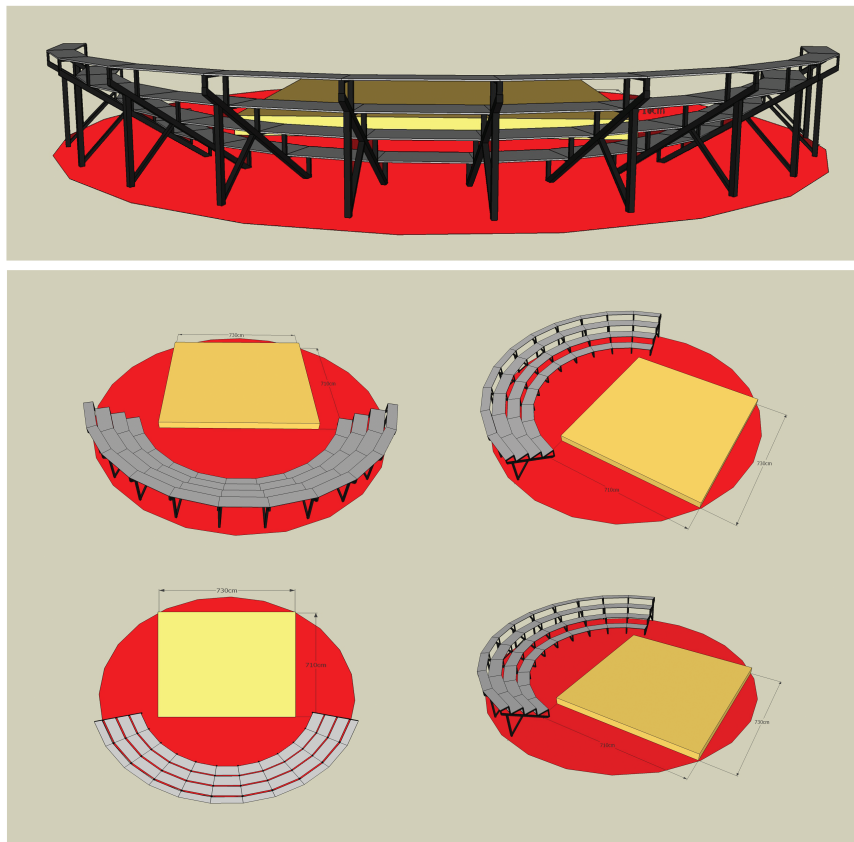

/ STAGE 7,10 mx 7,30 m material: wood

CIRKO BALKANA EQUIPMENT

/ LIGHT

21ch dmx dimmer

24ch dmx control, 24ch direct control or 12ch direct control
plus 48 memory (12ch x 4 sides)

par64 1000W x7

pc 500W x5

pc 1000W x5

par56 300W x4

profile 1000W x2

Fixed positioning of the lights in the space:

- above the audience, centrally, for the headlights, the 3.5mm diameter, the width of 2m
- at the bottom of the stage at a height of 3m, width 6m
- each of main poles has holder at a height of 4.5 m, 1.5 m wide.

All the necessary cables for connecting the lighting

/Lighting desk /EDistribution box /20m 32A cable

/ SOUND

/AUDIX FP7 DRUM SET 1 pcs

1 x Audix f5 (snar)

3 x Audix f2 (rack and floor volumes)

1 x Audix f6 (bass drum)

2 x Audix f9 (overhead, cymbals, hi-hat)

/RODE M1 Dynamic Microphone LIVE 2 pcs

/BEHRINGER DI 600P ULTRA DI 2 pcs

/GRAVITY MS4322B Mic Stalak small 1 pcs

/GRAVITY Mic.St.veliki MS4321B 4 pcs

/Adam Hall K20C30 Stage box 16/4 30m multicore

/TURBO SOUND M12 MILAN 2 pcs

/TURBO SOUND IQ18B ACTIVE SUBWoofer 1 pcs

/Yamaha 01V digital mixer 16ch

СІРКОБАЛКАНА

IMO

identified
mobile
objects

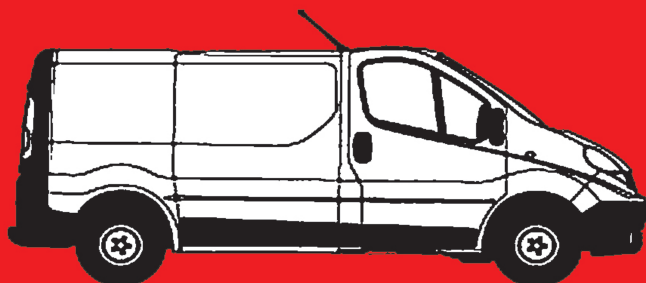
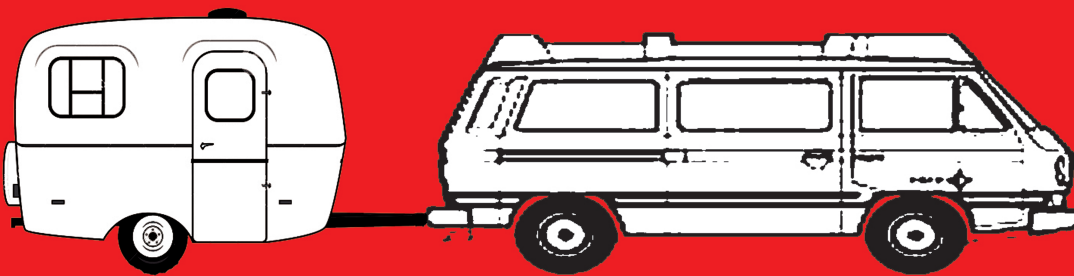
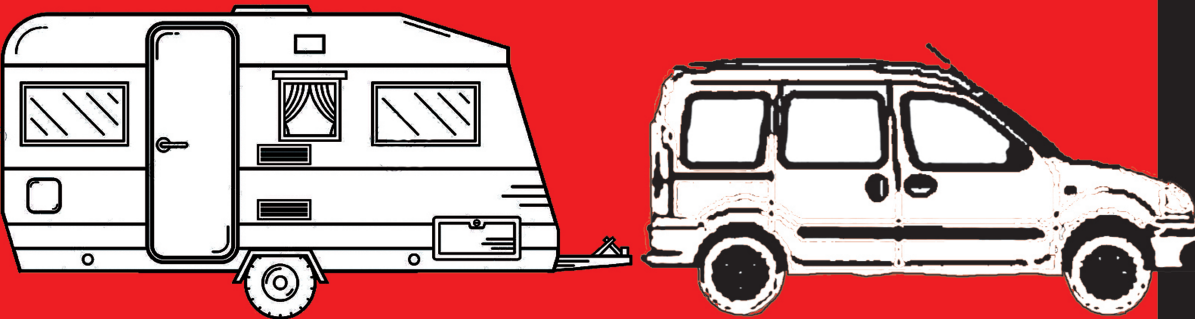
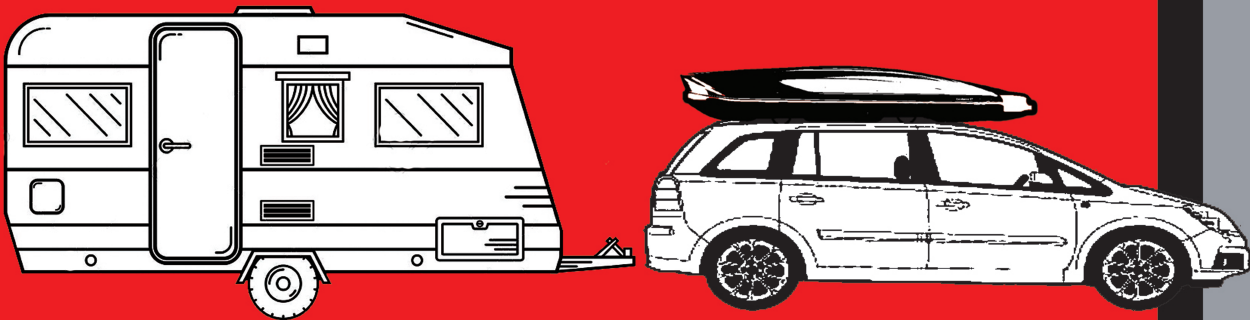

/ VEHICLES

Truck + cargo trailer for tent

Van vehicle for pins and technique

2 x Personal car + camping house

Van vehicle + camping house



/ WHAT SHOULD CLIENT ENSURE!!!

- Possible access with trailer and vans to the terrain where a tent will be placed
- Plan of underground installations (position I depth). In case of delivery of incorrect plans for underground installations (electricity, water, sewage, gas, telephone ...) the client is responsible and bear the costs
- Minimum depth of entry of pins into the ground 50 cm (depending on terrain even deeper)
- Power connection 32A, distance max. 20m from tent. If the distance is higher, it need extra cable or pulling the connector closer to the tent
- Drinking water connection
- License for the installation of our vehicles (van, caravan ...) in a circle around the tent
- Sanitary facilities (toilet, shower, hot water ...) near the installed vehicles around the tent
- Heating for the tent (in case of cold seasons)
- Protective fence around the tent (depending on the place where the tent will be placed)
- Sanitary facility for audience (chemical toilet), in proportion to the number of seats

THANK YOU.

CIRKOBALKANA